

UNDERCOUNTER ICE MACHINES

Air Cooled, Full Cube - 280 Lbs.

FEATURES

- ▷ Durable #304 stainless-steel exterior
- ▷ Digital controller notifies user of any issues, stage of production, cleaning cycle, and adjusts ice thickness
- ▷ Air filter is easily removable for cleaning
- ▷ Includes Basic PP water filters
- ▷ Includes adjustable legs for leveling your ice machine
- ▷ Includes ice scoop

ICE STYLE

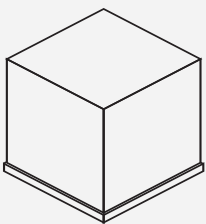

Full Cube
7/8" x 7/8" x 7/8"

This unit produces full cube size ice.

24 HOUR ICE PRODUCTION

70°F air	280 lb.
90°F air	240 lb.



Model SK-289

WARRANTY

RESIDENTIAL INSTALL: Snooker assumes no liability for parts or labor coverage for component failure, factory defect or any other damages for units installed in non-commercial foodservice or residential applications.

1 Year Parts & Labor
3 Years Compressor

Conforms to UL & NSF-7 Standards



UNDERCOUNTER ICE MACHINES

Air Cooled, Full Cube

MODEL SK-289

PLAN VIEW

FRONT VIEW

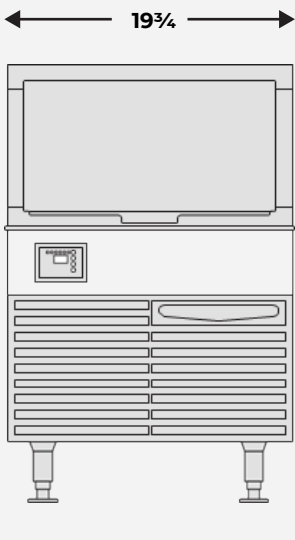

SIDE VIEW

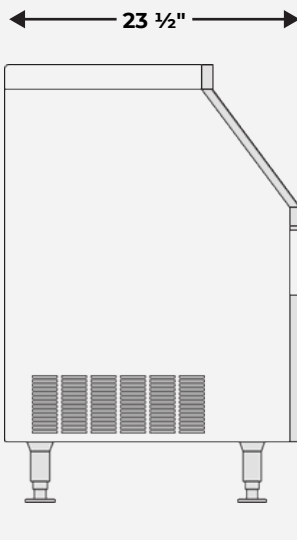

TOP VIEW

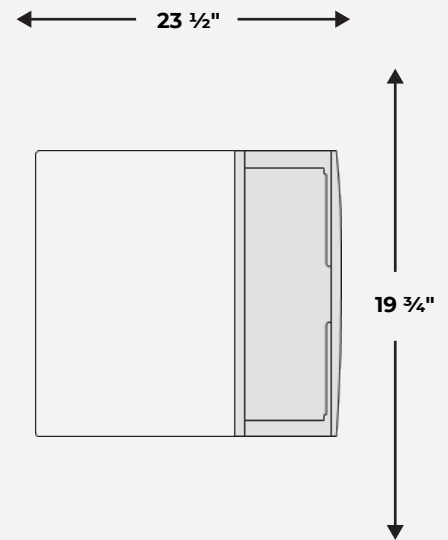

TECHNICAL DATA

Installation Requirements

Ambient Temperature Range	40° to 90°F
Water Temperature Range	40° to 90°F
Water Pressure Range	18.75 psi min; 80 psi max
Potable Water Usage	15.5 gal/100 lbs. ice

Dimensions

Unit Dimensions	26"W X27"D 39"H
Net Weight	136 lb.
Gross Weight	150 lb.
Packaging Dimensions	20"W x 30"D x 36"H

Electrical

Voltage	115
Amps	8.6
Hz	60
Phase	1
Plug Type	NEMA 5-15P
BTU/hr	2477
Power kWh/100 lbs. Ice	8.7
Refrigerant	R290

Included



Scoop



Water Outlet Hose

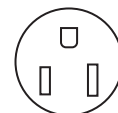

NEMA 5-15P